

Over Head Door  
13'6" x 15'

Emergency Exits

Emergency Exits

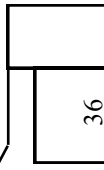
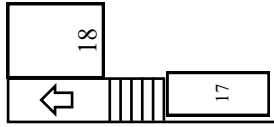

100 Isle



200 Isle

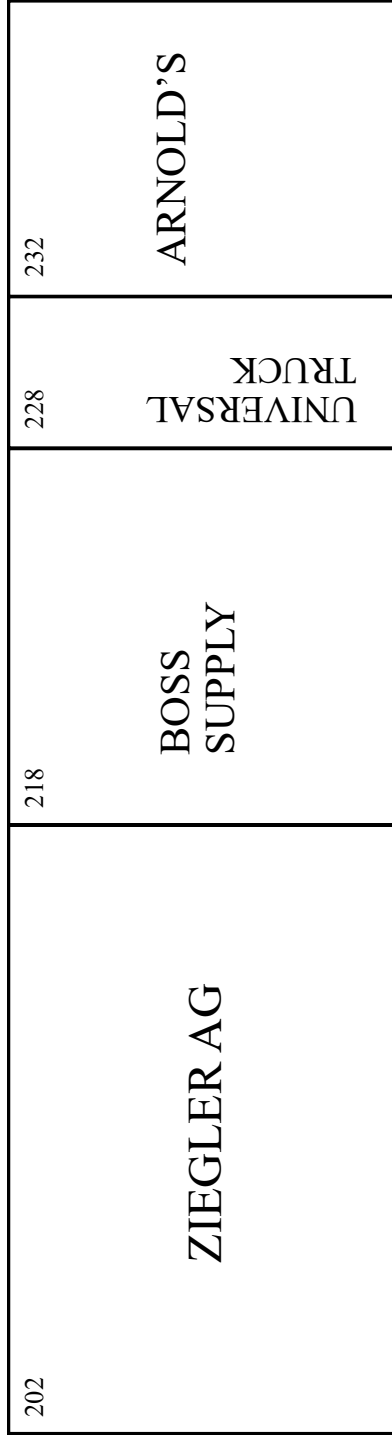

300 Isle

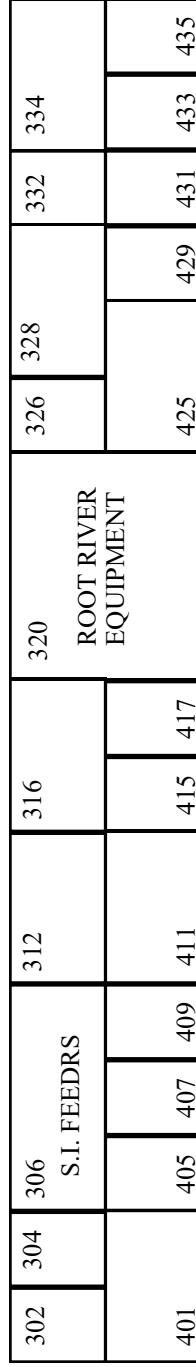

400 Isle

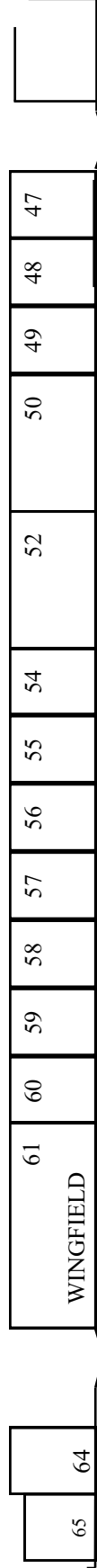

Walkway

Hydrant

Storage

Hydrant

Public Entrance

Storage

To West Side &  
Main Lobby

Emergency Exits

Over Head Door  
14'6" x 17'

Over Head Door  
14'6" x 17'

Emergency Exits

# Four Seasons East Side



# Four Seasons West Side

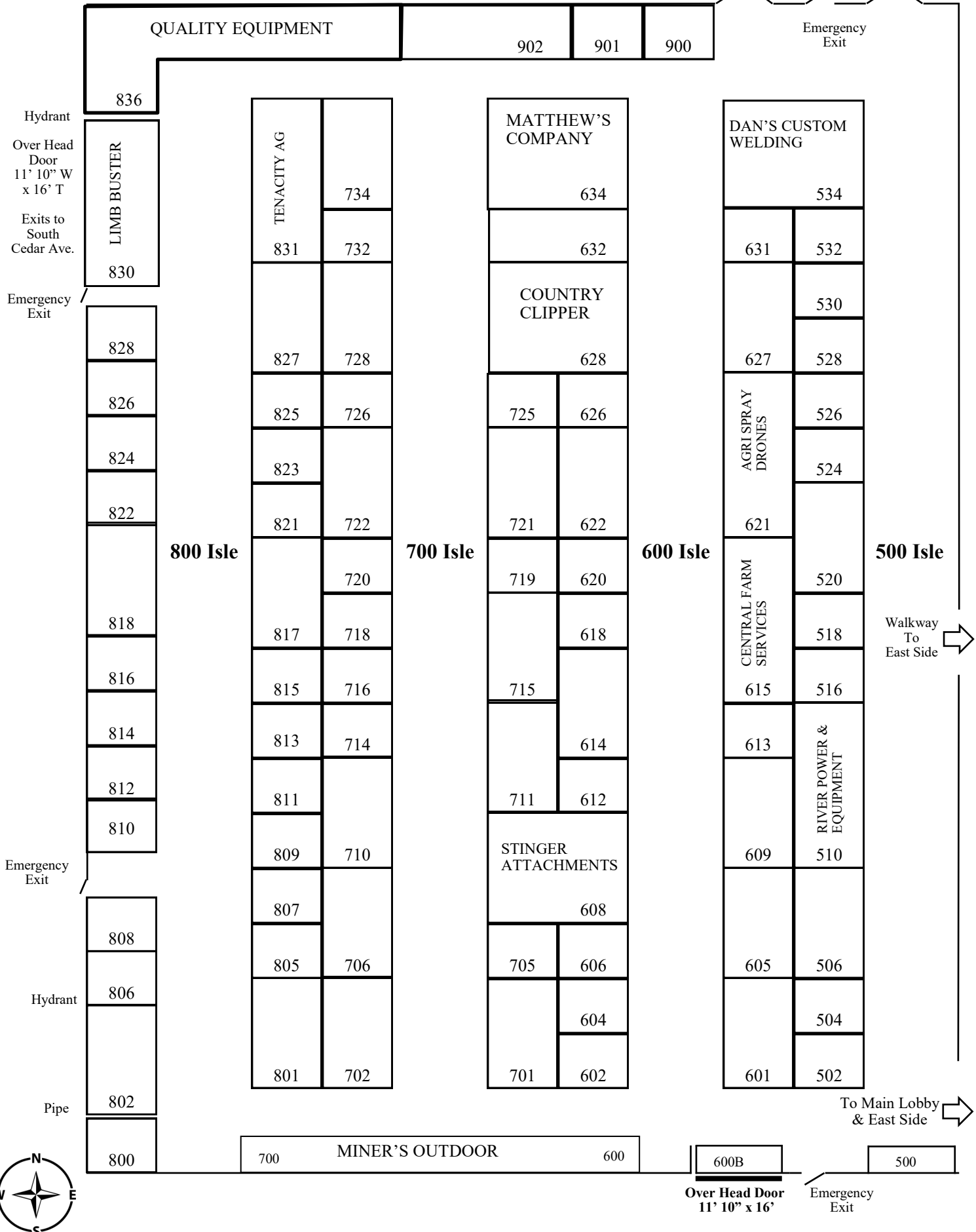

Over Head Door  
11' 10" W x 16' T

### West Four Seasons Centre

Over Head Door  
11' 10" x 16'

LOBBY

Over Head Door  
14'6" x 17'

### East Four Seasons Centre

Over Head Door  
13'6" x 15'

Over Head Door  
14'6" x 17'

9<sup>th</sup> Street

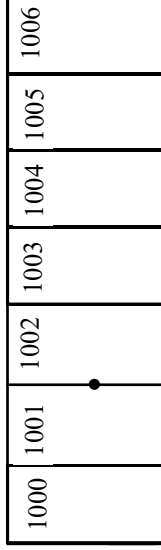

ATTENDEE PARKING

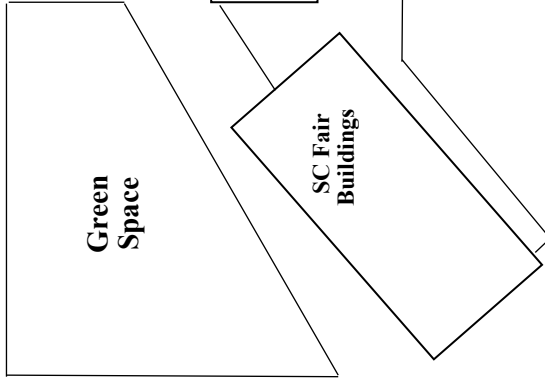

Green  
Space

SW 18<sup>th</sup> Street SE

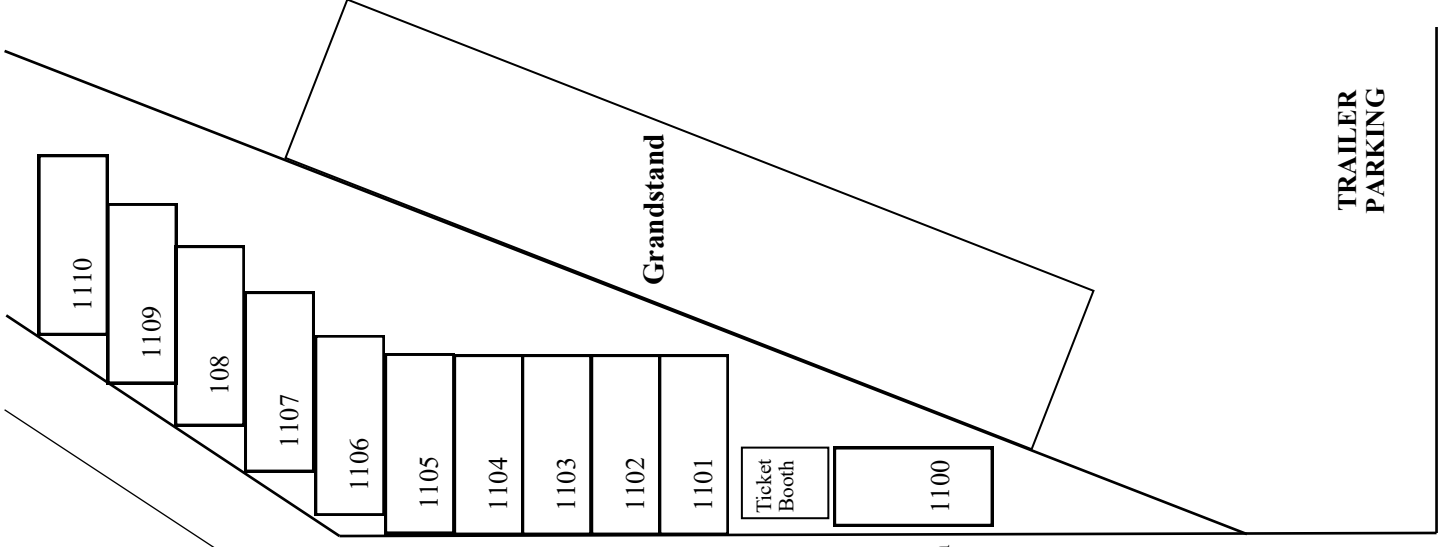

South  
Elm  
Ave.

SW 18<sup>th</sup> Street SE